

A part of Lot Seven (7) in Block numbered Nineteen (19) Plat "A" of Ogden City Survey, described as follows:

Commencing at a point 105 and three-fifths feet East of the North-west corner of said Lot, thence east 59 and two-fifths feet, thence south 132 feet, thence West 59 and two-fifths feet, thence North 132 feet to the place of beginning.

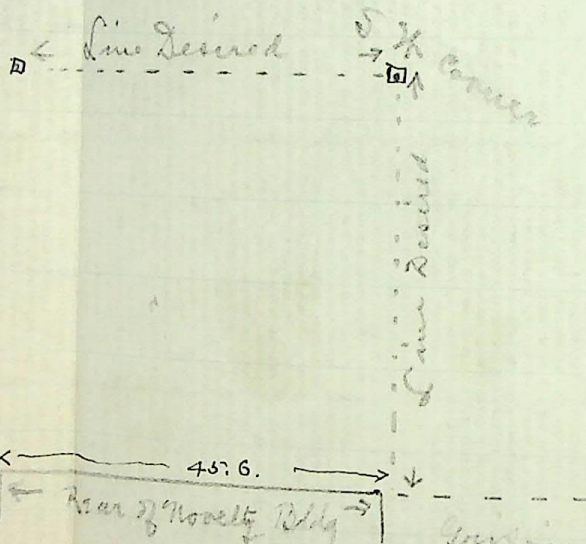

Would like to have the south-west corner of this parcel located also the west line from said corner to the rear of building and the south line of the lot to a point south of the south-east corner of the old Novelty Building proper.

Yours

Geo E. Manda